



VALVES PRO
WWW.VALVESPRO.COM



流体自控阀门专用 电动执行器

Automatic control valve for fluid Electric Actuator

水、空气、蒸气、油、气体、真空等流体

Water, air, steam, oil, gas, vacuum and other fluids

Wenzhou Valvespro Flow Control Technology Co.,Ltd

Add : NO.649-1 Jingde West Road Guoxi Road Ouhai District,

Wenzhou, Zhejiang Province, China.

Tel: 86-577-86115146

Fax: 86-577-86110708

Email : sales@valvespro.com

Skype: shaozhiqiang1688

Whatsapp: +8613777771223

Viber : 008613777771223

ICQ: 652452871

Web: www.valvespro.com

Wenzhou Valvespro Flow Control Technology Co.,Ltd

公司简介

Company Profile



Wenzhou Valvespro Flow Control Technology Co., Ltd is a hi-tech company specializing in R&D and manufacture of electric and pneumatic actuators and automatic control valves. Boasting strong technical strengths, Advanced production processes, complete testing equipment, excellent product performance, CAD development design, CIMS computer network management, machining centers and CNC tools. It's active in implementing the management standards of the ISO9000 quality certification system and all of its products have been certified by CE.

Our company has provided hundreds of thousands of sets of electric actuators, Electric ball valves, various electric butterfly valves and pneumatic ball valves, pneumatic butterfly valves, Pneumatic electric control valves. They are widely applied for automatic fluid control projects and equipment transformation in natural gas, oil, chemical engineering, Metal smelting, Paper making, Printing and dyeing, Electricity, Mining, Biopharmacy, Household chemicals, Food and beverage, Wastewater treatment, Air handling, Mechanical equipment and other industries.



Our company provides users with consulting, Design, Type selection, Installation and solving of various control programs, And maintains an honest operation policy with quality and customers first, Aiming for availability, Credibility and reliability to establish a first-rate brand of valvespro. With preferential prices and excellent after service, We warmly welcome both domestic and foreign customers to visit us, Do business with us, Establish a long-term cooperation relationship with us, Share valvespro's technical resources and jointly expand both domestic and overseas markets of control valves.

产品展示

Product Introduction



电动执行器

Electric Actuator



产品特性

Product Characteristics

- 外壳：
防水等级IP67（符合户外使用测试标准）。
壳罩部份使用耐高温、耐酸碱、耐撞击等的铝合金材质。
Enclosure:
IP67 rated waterproof and dustproof enclosure. The enclosure is made of Aluminum which can resist against heat, acid, and alkali. Aluminum enclosure is optional.
- 马达：
体积小、低耗电、大扭力。全系列马达绝缘等级为F级。马达内部标准均配有过热保护装置，有效避免马达过热故障。
Motor:
It is small, low consumption, and has large torque.
The insulation class of all models is F class.
There is overheating protection device in the motor, which can protect the motor from overheating.
- 开度指示：
全系列电动执行器产品均在顶部配有机械式指针开度指示器。
也可经由配线至控制箱，由指示灯显示开度位置。
Position Indicator:
All models have a constant mechanical position indicator on the top of the actuator cover to indicate the position of the valve. It can also be wired to the control box, and it will show the opening position via indicator signal.
- 手动装置：
全系列电动执行器均配有手动装置，提供停电时操作，可使用板手或是手轮操作（依型号有所不同）。
Manual Override Device:
There are manual override device in the electric actuator, which is used when the power supply is cut. You can use wrench or hand wheel to adjust.
- 阀体连接座：
直接锁入球阀或蝶阀等需符合ISO5211规范。
不符合ISO5211规范或使用蒸汽、高温流体时，需采用托架式连接组合。
Flange/Mounting Type (ISO5211):
VSE-1 to VSE-12 provides direct mounting on ISO5211 valves. If the valve doesn't apply with ISO5211, the fluid is steam or other high temperature fluid, it needs to use the mounting kit to mount the electric actuator and valve.

- 工作条件:
环境温度: $-10^{\circ}\text{C}\sim 70^{\circ}\text{C}$
湿度: 30%-95%
Working condition:
Ambient temperature: $-10^{\circ}\text{C}\sim 70^{\circ}\text{C}$
The Humidity: 30%-95%
- 特殊电压:
电动执行器常规电压: AC220V、DC24V AC380V (VSE-3起)
例: AC110V、AC400V等, 可依客户需求定制
Special Voltage:
For example: three-phase voltage 220V/380V/440V is available

选型步骤 (一)

Selecting Step(1)

- 步骤1: 请先确认所安装阀体扭力是否小于电动阀输出扭力值。
阀的扭力值建议空载扭力乘以安全系数
(100Nm以内乘以1.5; 100Nm以上乘以1.3)
例如: 阀体最大扭力值40Nm, $40 \times 1.5 = 60\text{Nm}$
 $60 > 50\text{Nm}$ (VSE-1 15W) = 不适合安装
 $60 < 70\text{Nm}$ (VSE-2 15W) = 适合安装
Step1: Please check whether the torque of the valve is less than the torque of the actuator.
Safety Formula (Ball Valve for example):
Torque: under 1000 kgf-cm 2×1.5 / over 1000 kgf-cm 2×1.3

- DC24V电动执行器
以下数值仅供参考。
使用压力超过10bar以上, 电动执行器需加大一码。
需加装比例式或阀体旋转扭力过紧时, 电动执行器需加大一码。
DC24V Electric Actuator Product Specification
The following values are based on 60Hz as reference.
The value varies slightly from the different frequency of the power supply.
If the working pressure is more than 10kgf-cm 2 , you should replace it with a bigger one.
If you need to install modulating series or the torque of valve is too tight, you should replace it with a bigger one.

型号 Models	功率 Power	开关时间(S) Speed	扭力值 ($\pm 5\%$) NM Torque ($\pm 5\%$)	额定电流 Rated Current
JYL-02	10W	10	25	0.5A
JYL-03	10W	3	20	0.5A
JYL-03	10W	5	25	0.5A
JYL-03	10W	15	40	0.5A

产品规格

Product Specification

- AC110~AC220V电动执行器
以下数值仅供参考, 接入电源频率不同时数值略有出入。
使用压力超过10bar以上, 电动执行器需加大一码。
需加装比例式或阀体旋转扭力过紧时, 电动执行器需加大一码。

AC110V~AC220V Electric Actuator

The following values are based on 60Hz as reference. The value varies slightly from the different frequency of the power supply. If the working pressure is more than 10kgf-cm 2 , you should replace it with a bigger one. If you need to install modulating series or the torque of valve is too tight, you should replace it with a bigger one.

型号 Models	功率 Power	开关时间(S) Speed	扭力值 ($\pm 5\%$) NM Torque ($\pm 5\%$)	额定电流 Rated Current
JYL-02	20W	12	25	0.25A
JYL-03	10W	12	35	0.25A

接线图

Wiring Diagram

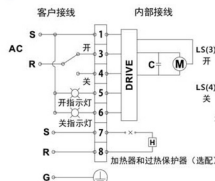
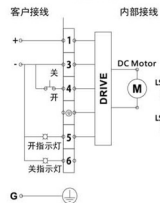
VSE-1-S~VSE-12
AC110/220V接线图VSE-1-S~VSE-12
DC24V接线图

VSE-1-S~VSE-12

AC110/220V WIRING DIAGRAM

Wiring Diagram-Client

Wiring Diagram-Interior of actuator

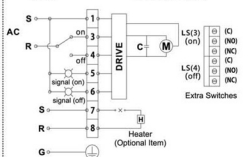
VSE-1-S~VSE-12
DC24V WIRING DIAGRAM

Wiring Diagram-Client

Wiring Diagram-Interior of actuator

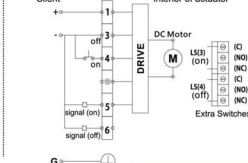

安装阀体参考图

Valve Application

- 直结式
- 以下数值为出厂空载测试
- 直结式安装之阀体规范须符合ISO5211
- 安装仍需参考阀体实际扭力值X安全系数为准(1000kgf-cm² 以内乘以1.5; 1000kgf-cm² 以上乘以1.3)
使用压力如超过10Kgf-cm² 以上,电动执行器需加大一号。
加装比例式或阀体旋转扭力过紧时,电动执行器需加大一号。
Direct Mount Series
The following values is under no load test.
Direct Mount Type-The valves has to be in accordance with ISO5211
Safety Formula (Ball Valve for example):
Torque: under 1000 kgf-cm² x 1.5 / over 1000 kgf-cm² x 1.3
If the working pressure is more than 10 kgf-cm², you should replace it with a bigger one.
If you need to install modulating series or the torque of valve is too tight, you should replace it with a bigger one.

型 号 Model	阀体规格 The Size Of Valve			适用压力 Max Operating Pressure (Kgf-cm ²)
	内螺纹球阀 Ball Valve (Screw Ends)	蝶阀 Butterfly Valve	三通内螺纹球阀 3-port Ball Valve (Screw Ends)	
JYL-02	1/4"~1"	1"	1/4"~1/2"	10
JYL-03	1"~1 1/2"	1 1/4"~3"	1/2"~1 1/2"	10

安装阀体参考图

Valve Application

- 托架式
- 以下数值为厂内空载测试
- 安装仍需参考阀体实际扭力值X安全系数为准
(1000kgf-cm² 以内乘以1.5; 1000kgf-cm² 以上乘以1.3)
使用压力如超过10Kgf-cm² 以上,电动执行器需加大一号。
加装比例式或阀体旋转扭力过紧时,电动执行器需加大一号。
Mounting Kit Series
The following values is no load test.
Safety Formula (Ball Valve for example)
Torque: under 1000 kgf-cm² x 1.5 / over 1000 kgf-cm² x 1.3
If the working pressure is more than 10kgf-cm², you should replace it with a bigger one.
If you need to install modulating series or the torque of valve is too tight, you should replace it with a bigger one.

型 号 Model	阀体规格 The Size Of Valve						适用压力 Max Operating Pressure (Kgf-cm ²)
	内螺纹球阀 Ball Valve (Screw Ends)	法兰球阀 Ball Valve (Flanged Ends)	PPVC 双由令球阀 True Union Valve (PLASTIC)	蝶阀 Butterfly Valve	三通内螺纹球阀 3-port Ball Valve (Screw Ends)	三通法兰球阀 3-port Ball Valve (Flanged Ends)	
JYL-02	1/4"~1"	1/2"	1/2"~1 1/2"	1"~2"	1/4"~1/2"	1/4"~1/2"	10
JYL-03	1"~1 1/2"	3/4"~1"	2"~2 1/2"	2"~3"	1/4"~1"	1/2"~1"	10

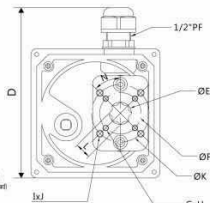
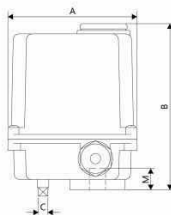

JYL-03 10 - AC110 - 10 - □ - □

型号
Model

电压
Voltage

AC220V/50/60Hz
AC110V/50/60Hz
DC24V

功率
Power

AC : 10W
15W
DC : 10W

无源触点
Extra Switches

□ : 标准 (无)
Without Extra
Switches

加热器
Heater

□ : 标准 (无)
Without Heater (Standard)
H : Heater

开 关
时 间
Speed
AC : □ : 12秒 (标准)
12S (Standard)
2S : 2.5S
DC : □ : 15S (标准)
15S (Standard)
3 : 3S
5 : 5S

mm

型号 Model	A	B	C	D	E	F	G	H	I	J	K	L Max	M	N	ISO 5211
JYL-03	118	145	8	140	19.3	36	M5	4	M6	4	50	14.03	19	45*	F03 / F05

JYL-02

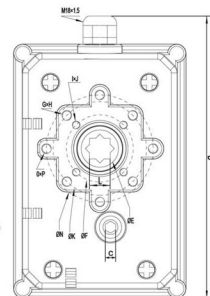
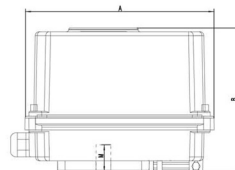

JYL-02- 10 - AC110 - 10 - □ - □

型号
Model

电压
Voltage

AC220V/50/60Hz
DC24V

功率
Power

AC : 10W
15W
DC : 10W

无源触点
Extra Switches

□ : 标准 (无)
Without Extra
Switches

加热器
Heater

□ : 标准 (无)
Without Heater (Standard)
H : Heater

开 关
时 间
Speed
AC : □ : 10秒 (标准)
10S (Standard)
5 : 5S
DC : □ : 10S (标准)
10S (Standard)
5 : 5S

mm

型号 Model	A	B	C	D	E	F	K	N	IXJ	GXH	OXF	M	L	ISO 5211
JYL-02	136	133	5	160	20	36	50	57	4xM5	4xM6	4xM6	20	11	F03/F05

选配项目

Optional Items



选配项目

Optional Items

加热器 Heater



调节型 Modulating Controller



整体型模块 Integrated Module



可变电阻 Variable Resistance



微电脑恒温控制器
Micro-computer Thermostatic Controller



简易现场控制器 Portable Controller

